

(EN) HEAD PROTECTION 3000 BAR: INSTRUCTIONS FOR USE

Art. no. 5102068 5000

Head Protection with Visor and Hearing Protections. All components are tested to protect the user against objects and sweeping high pressure water jets with pressures up to 3000 bar. The Head Protection also fulfills the requirements for Industrial Helmets. The interior is comfortable and can be adjusted for a very good fit. The Visor fulfills the requirements for Eye protection. It protects the user against external impact on eyes and face, front and side. It is replaceable and can be set in an upfolded position. Hearing Protection is certified for reduction of dangerous noise levels. SNR=32 dB. They can be adjusted in height for best protection and fit, and in different positions against the head.

BEFORE USE

Check that the interior is mounted at right places. Every time the Head Protection is used the Helmet, Visor and Hearing Protections should be inspected for cracks, jacks or other damage. If damage is detected, damaged parts should be discarded. Remove hair from the ears and take off earrings that can affect the seal, before you put on the Hearing Protections.

USE

Make sure the product is adapted for use and properly fitted. It should be used throughout the whole exposure period. Replace the product when needed. Proper product selection, training and maintenance are essential for the product to protect the wearer from risks of impact and sweeping water jets. Failure to comply with all instructions regarding the use of these personal protection products and/or failure to wear the products throughout the exposure period may seriously endanger the health of the user and lead to serious or life-threatening illness or permanent injury. There is a risk of injury if the helmet is modified or any of the original parts are removed, in addition to that recommended by the helmet manufacturer. The helmet should not be adapted for the purpose of mounting accessories other than those recommended by the manufacturer.

Do not apply paint, solvent, glue or self-adhesive labels other than in accordance with the instructions of the helmet manufacturer. Direct contact with sprays, liquids or other substances containing solvents and/or alcohol may impair the durability of the helmet and should therefore

be avoided. Use the helmet only in industrial operations, not as for example riding or cycling helmet.

COMBINATIONS

The Head Protection protects approx. 85% of head and face, and is recommended to be used in combination with TST Sweden's protective clothing for waterjetting.

CE-MARKING & TEST RESULTS

SS-EN397:2012 Industrial helmets
SS-EN166:2001 Eye protection
SS-EN 352-3:2002 Hearing Protection

The level of waterjet protection have been determined by testing according to the table below. Note! Different values, eg. pressure, flow, nozzle, distance or speed, can give significantly different results!

TECHNICAL INFORMATION

The Helmet is made of fiberglass reinforced polyamide. Temperature range -30 to +150 °C / -22 to 302 °F.

PRODUCT LIFETIME

Recommended lifetime 2-5 years, depending on the surrounding environment. Year of manufacture is marked/punched on the helmet. The helmet is made to absorb energy in strokes that partially destroy the helmet or cause damage to the shell or interior, and even if such damage is not easy to identify, a helmet exposed to severe impact should be replaced.

SIZES & FITTING

Size range: One size: 53-62 cm
Fitting: Adjustable helmet suspension

CLEAN & CARE



Helmet, interior and sweatband should be cleaned regularly with a mild detergent and warm water.

STORE

Store in the supplied bag in dry conditions and not in direct sunlight.

WASTE DISPOSAL

Dispose product in accordance with national regulations.

Pressure		Flow		Nozzle				RPM	Distance		Linear speed		Result
Bar	Psi	Litre/minute	Gallon/minute	Type	Quantity	Diameter mm	Diameter in.		mm	in.	m/s	in./sec	
2 000	30 000	17.9	4.7	 Single	1	0.8	0.031	-	75	3	0.5	20	No penetration
3 000	43 500	19.5	5.2	 Rotor	2	0.6	0.024	3 000	75	3	0.5	20	No penetration

(EN) HEAD PROTECTION 3000 BAR: MOUNTING INSTRUCTION

HEARING PROTECTIONS

Helmet attachment:

Insert the helmet attachment in the slot on the helmet and snap it into place (1).

Work mode:

Press the headband wires inwards until you hear a click on both sides (2). Make sure that the cups and the headband wires do not press on the edge of the helmet when in work mode as this could reduce the noise attenuation of the earmuff.

Ventilation mode:

To switch the unit from work mode to ventilation mode, pull outward on the ear cups until you hear a click (3). Avoid placing the cups against the helmet (4) as this prevents ventilation.

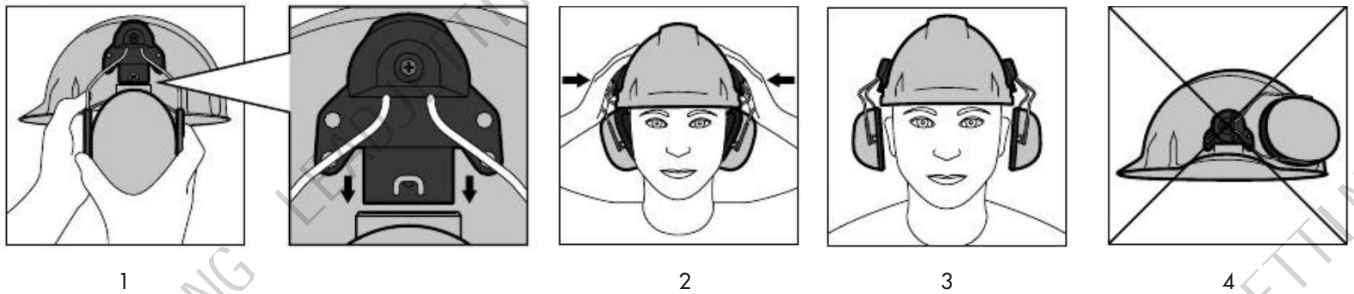

Illustrations: 3M

VISOR AND VISOR HOLDER

Helmet attachment:

Insert the visor holder attachments on the hearing protectors' helmet attachments and snap them into place (1).

Visor attachment:

Press the visor to the visor holder until you hear a click, one attachment at a time (2-5).

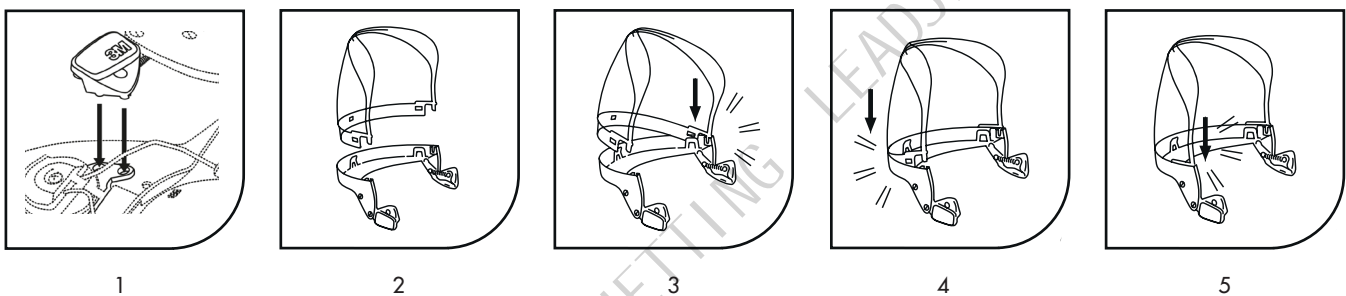

Illustrations: 3M